



# Mercedes-Benz Model: G-Class Series

## Installation instructions



Please read the instructions carefully before installing this product

**Points to note:** All the pictures in this manual are for reference only. The pictures and the objects are slightly different due to different models, but the installation method is basically the same.

## One: The mounting position on the car

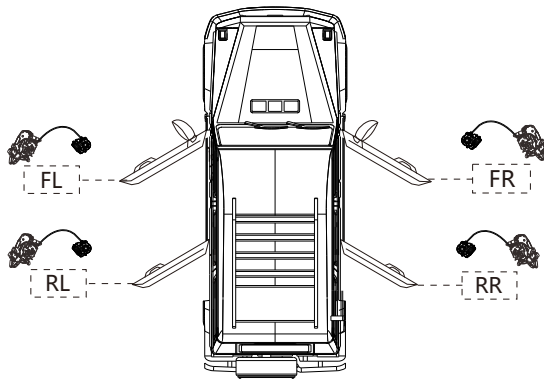

## Two: Parts list

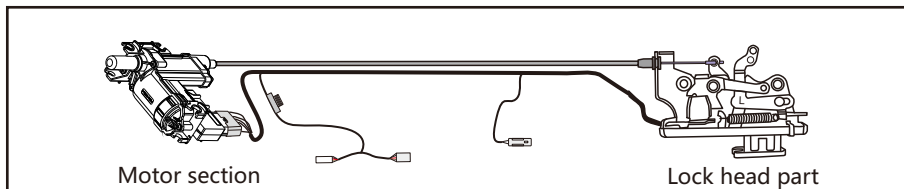

Automatic Door Lock  
Assembly

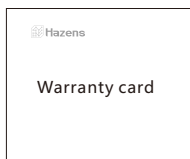

Warranty card



Certificate of conformity

## Three: Tools needed

Electrical tape, plastic pry knife, various specifications of the sleeve, Phillips Screwdriver, word screwdriver and sundry bucket.

# 1. Removal steps of main driving door panel

(Taking the main driving door as an example, the disassembly and assembly methods of the four doors are basically the same)

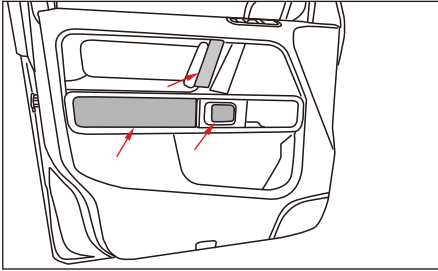

1. Remove inner door trim panel with tools.

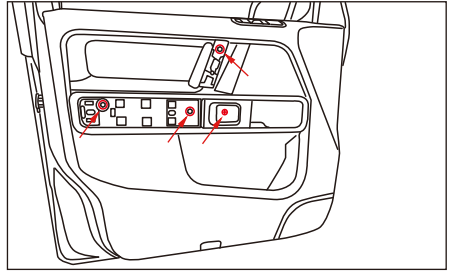

2. Remove the fixing screws of the inner door trim panel

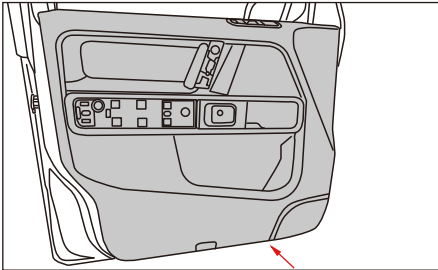

3. Removing inner door trim panel.

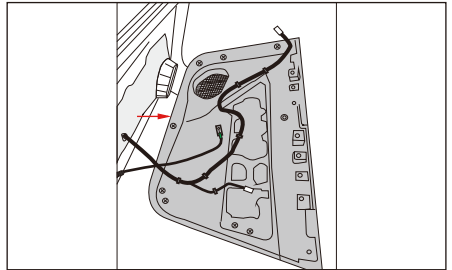

4. Pull off the wire harness and remove the inner door trim panel.

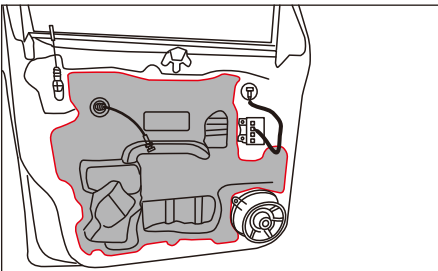

5. Use a utility knife to open waterproof and sound insulation cotton sealant along the edge.

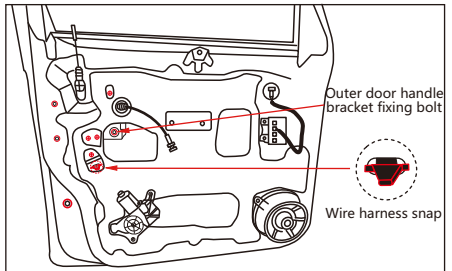

6. Remove the locking head associated part fixing bolt

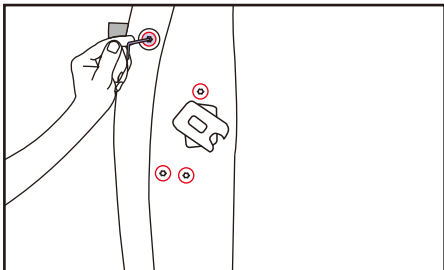

7. Remove the external door handle and lock retaining screws.

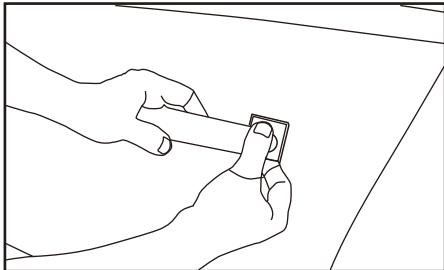

8. Remove the external door handle.

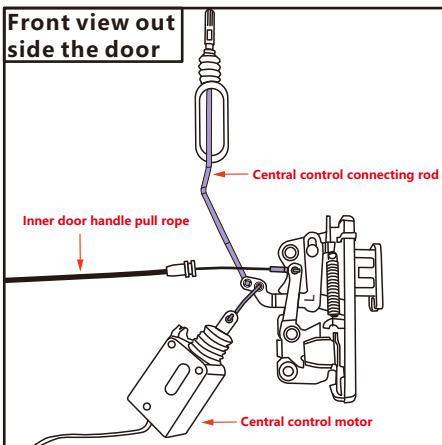

9. Remove the door lock

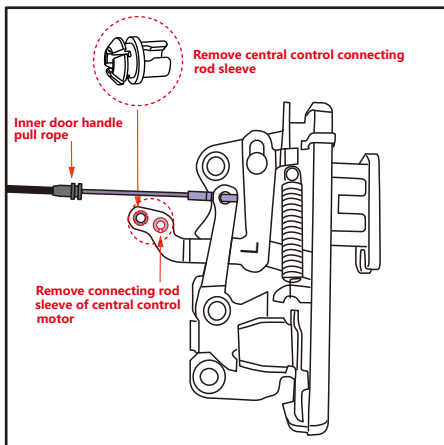

10. Remove the associated parts on the original door lock. (Install to electric suction lock)

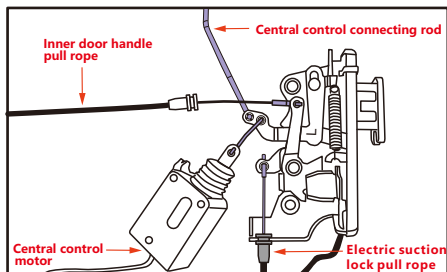

11. Remove parts and install them in the electric suction lock.

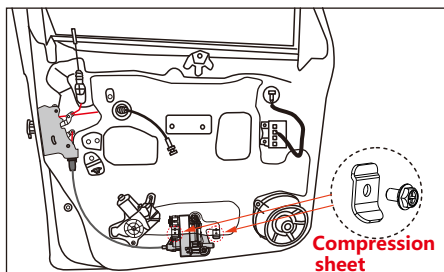

12. Place the pull rope and install the motor box bracket

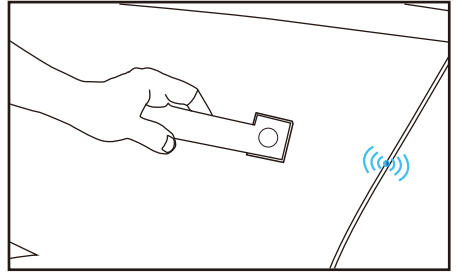
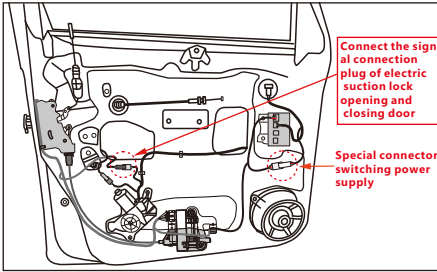

13. Connect the power connector and the electric suction lock door opening and closing detection signal connector at the same time.

14. Test the function of electric suction lock, and restore the decorative board if there is no abnormality

## 2. Rear left door motor mounting bracket steps

(Take the rear left door as an example, the installation method of the rear right door is basically the same)

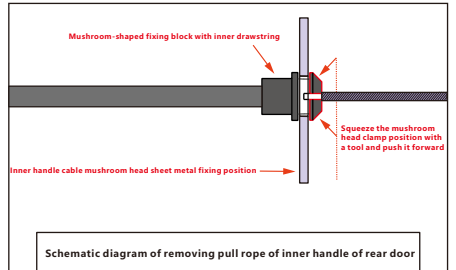
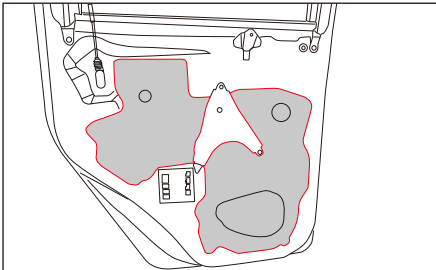

1. Use a utility knife to open waterproof and sound insulation cotton sealant along the edge.

2. Remove the rear door lock according to the front door lock method. **(Please remove the inner door handle pull rope according to the above figure)**

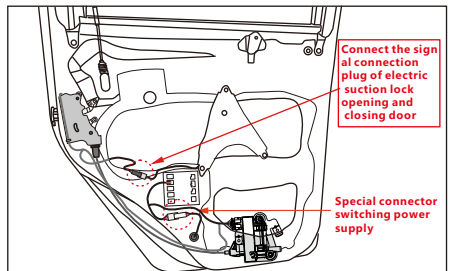
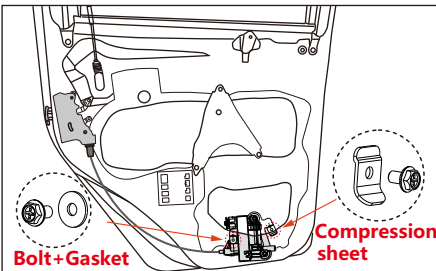

3. Place the pull rope and install the motor box bracket

4. Connect the power connector and the electric suction lock door opening and closing detection signal connector at the same time.

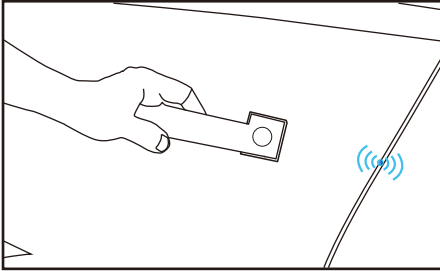

5. Test the function of electric suction lock, and restore the decorative board if there is no abnormality

**Points to note:** All the pictures in this manual are for reference only. The pictures and the objects are slightly different due to different models, but the installation method is basically the same.